



THE LANDINGS

PECAN PLANTATION

GRANBURY, TEXAS

AIRPARK

Lots 3170 - 3177
Do Not have taxiway access to the runway.

Lots 3178 - 3181
Will Not have taxiway access
The taxiway as seen on this map will be abandoned or these lots will be replatted prior to development construction.

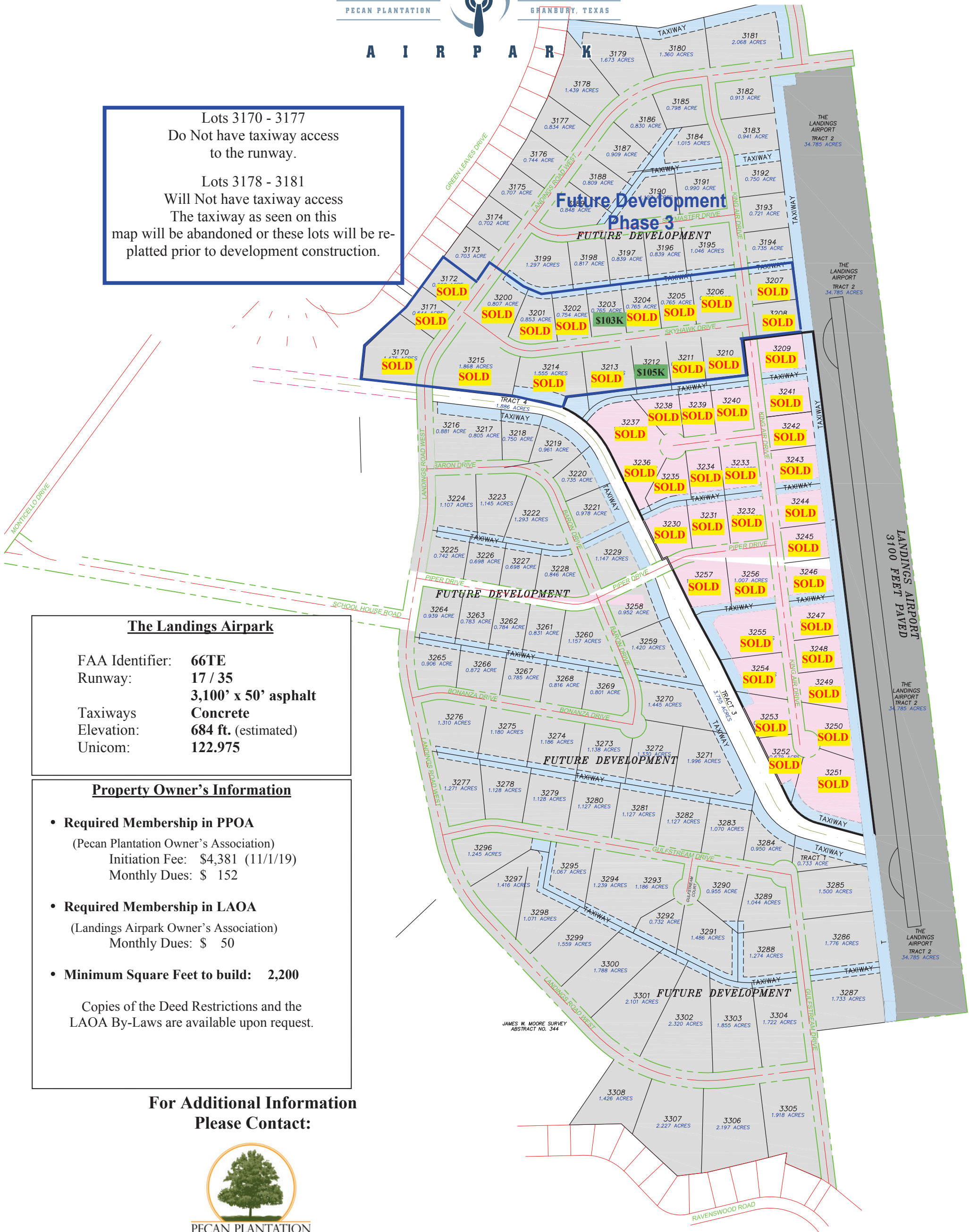

The Landings Airpark

FAA Identifier: **66TE**
Runway: **17 / 35**
3,100' x 50' asphalt
Taxiways **Concrete**
Elevation: **684 ft. (estimated)**
Unicom: **122.975**

Property Owner's Information

- **Required Membership in PPOA**
(Pecan Plantation Owner's Association)
Initiation Fee: \$4,381 (11/19)
Monthly Dues: \$ 152
- **Required Membership in LAOA**
(Landings Airpark Owner's Association)
Monthly Dues: \$ 50
- **Minimum Square Feet to build: 2,200**
Copies of the Deed Restrictions and the LAOA By-Laws are available upon request.

For Additional Information
Please Contact:



John Anthony

C: (817) 223-2237

O: (817) 910-9195

John@pecanplantation.com

www.pecanplantation.com

Prices and Availability are subject to change without notice.

November 6, 2019

