



THE LANDINGS

PECAN PLANTATION

GRANBURY, TEXAS

AIRPARK

Lots 3170 - 3172
Do Not have taxiway access
to the runway.

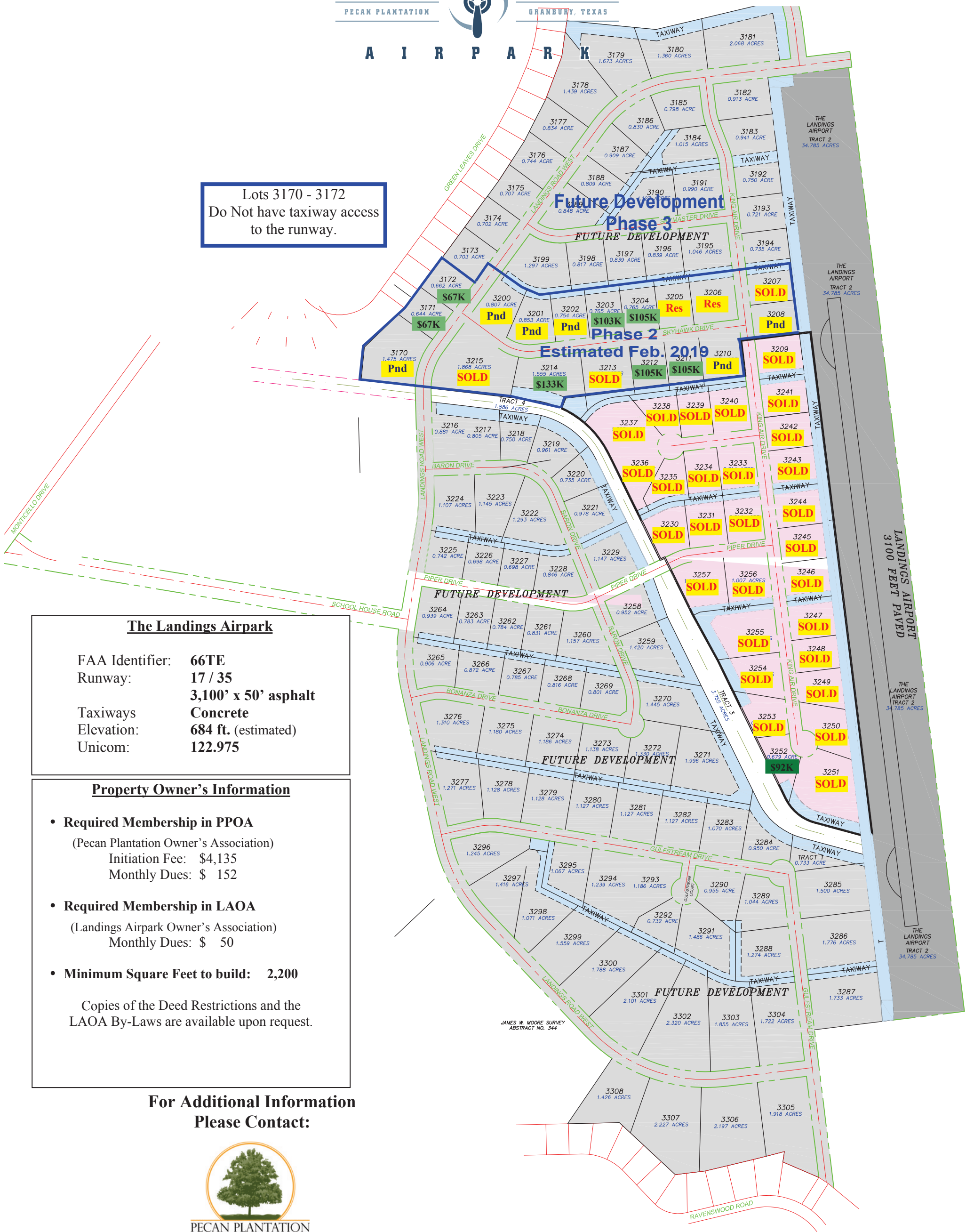

The Landings Airpark

FAA Identifier: **66TE**
Runway: **17 / 35**
3,100' x 50' asphalt
Taxiways **Concrete**
Elevation: **684 ft. (estimated)**
Unicom: **122.975**

Property Owner's Information

- **Required Membership in PPOA**
(Pecan Plantation Owner's Association)
Initiation Fee: \$4,135
Monthly Dues: \$ 152
- **Required Membership in LAOA**
(Landings Airpark Owner's Association)
Monthly Dues: \$ 50
- **Minimum Square Feet to build: 2,200**

Copies of the Deed Restrictions and the LAOA By-Laws are available upon request.

For Additional Information
Please Contact:



John Anthony

C: (817) 223-2237
O: (817) 910-9195

John@pecanplantation.com

www.pecanplantation.com

Prices and Availability are subject to change without notice.

March 27, 2019

